

City of Hawkinsville, Georgia

NWI DELINEATED WETLANDS MAP

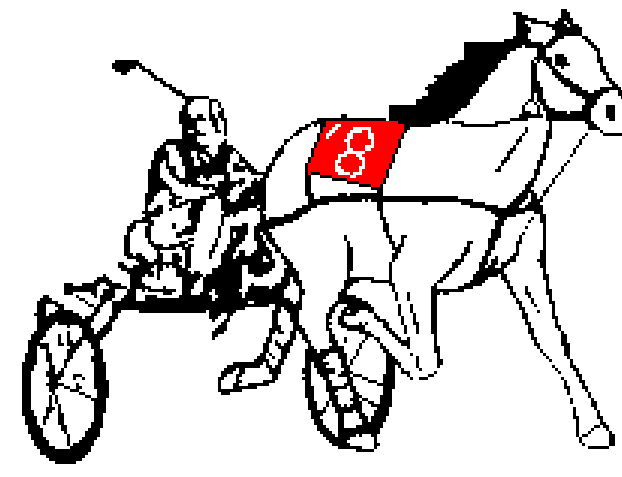

Where
Progress
Sets
the Pace

Inset of Golf Course Inside City Limits

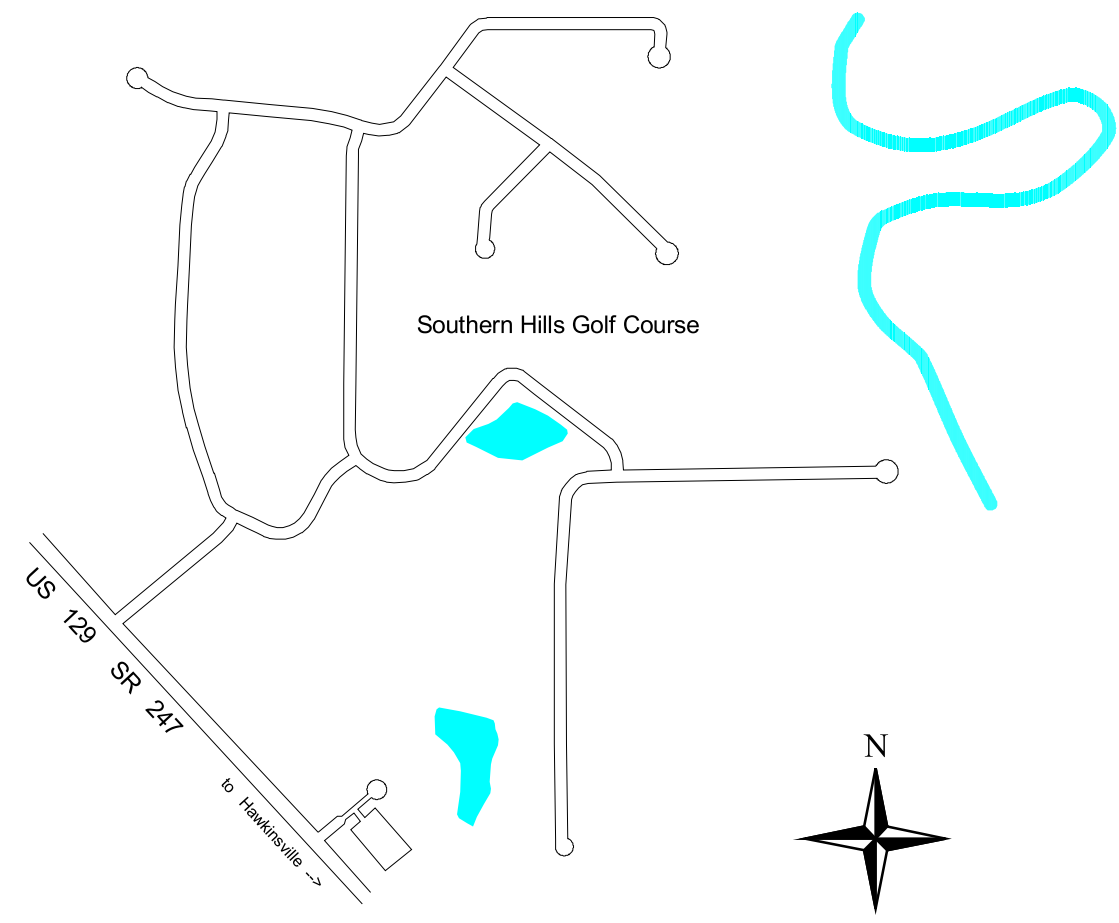

Location of Pulaski County In Georgia

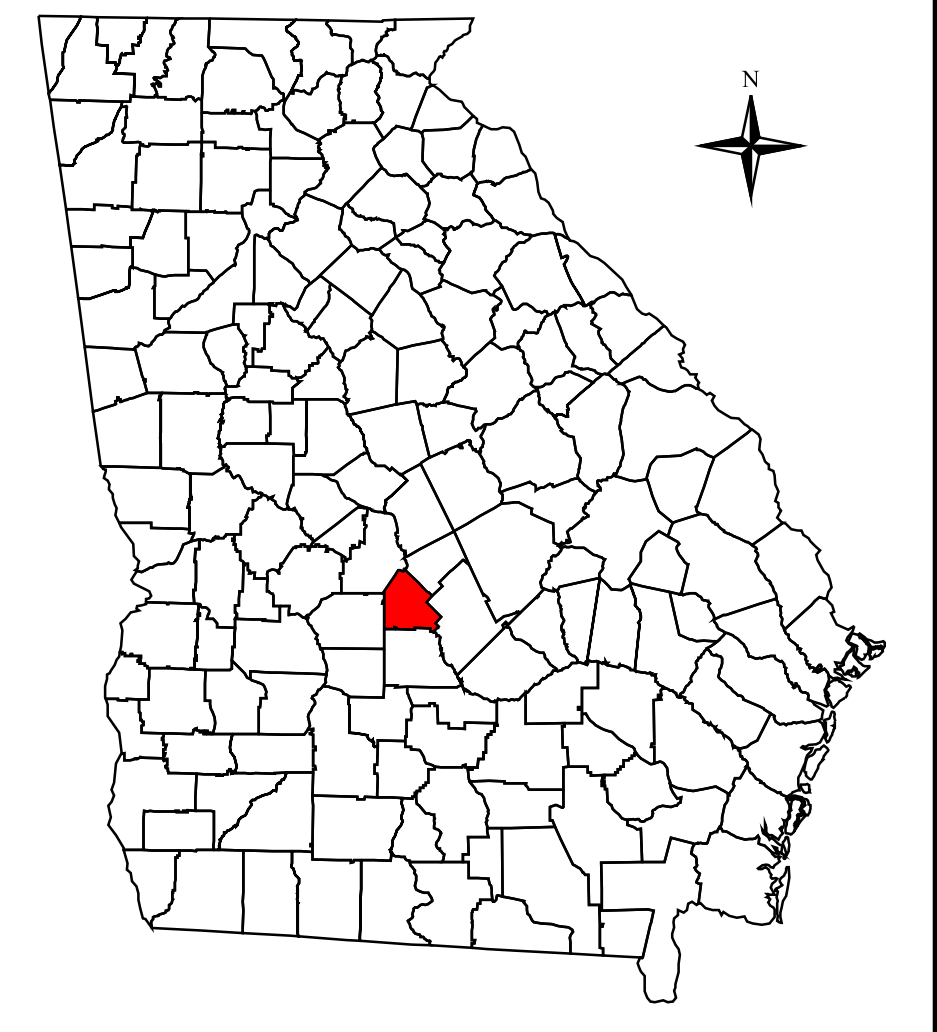

Location of Hawkinsville in Pulaski County

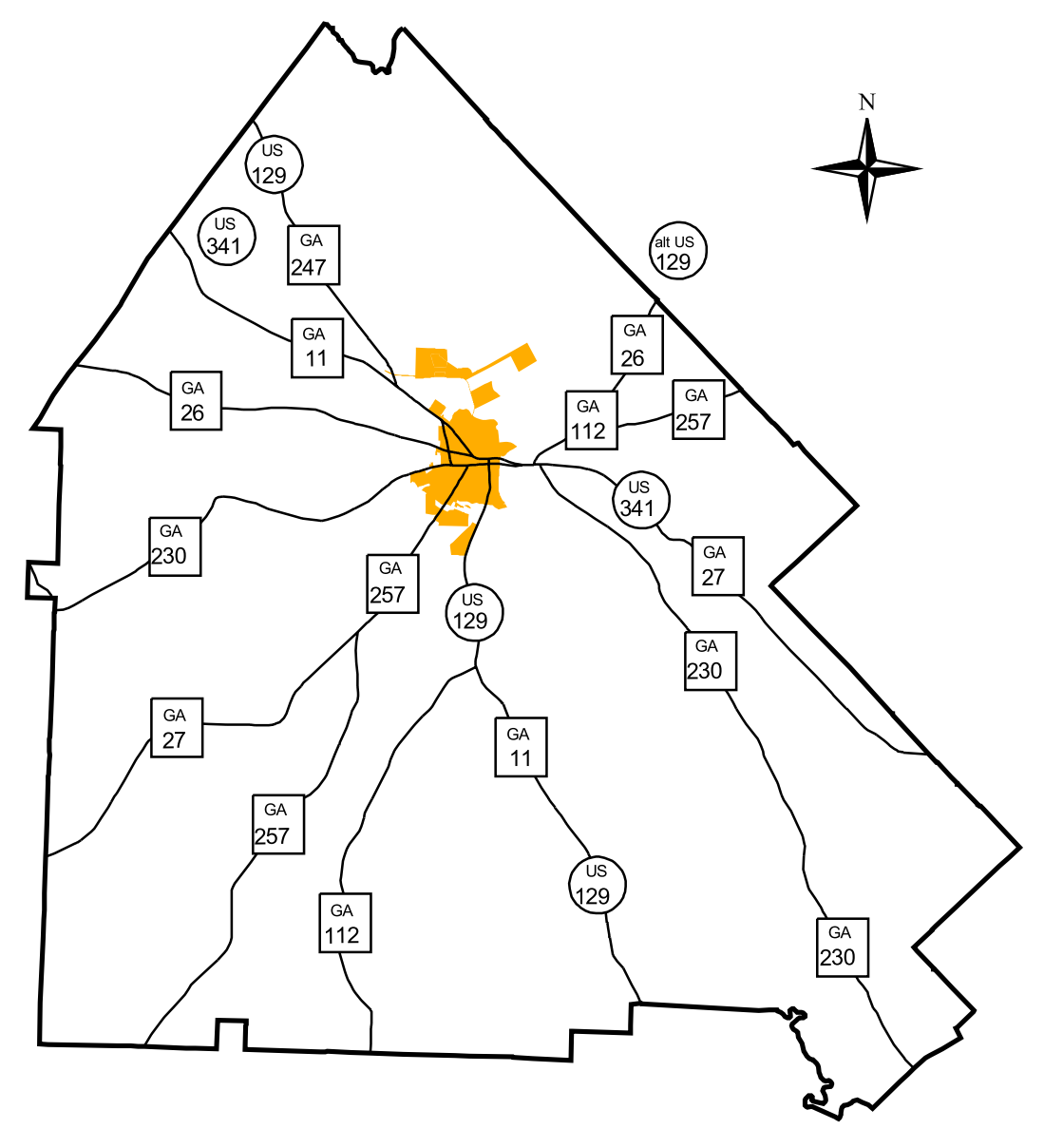

Digital Data Source Information

The spatial data elements represented on this map series were compiled in 1998 by the Middle Georgia Regional Development Center. Certain geographic features were mapped using global positioning system (GPS) satellite technology.

Other sources for digital, spatial data represented on this map series include: the U.S. Geologic Survey (USGS), the Federal Emergency Management Agency (FEMA), the U.S. Census Bureau, the U.S. Department of Agriculture, the Pulaski County Tax Assessors Office, the City of Hawkinsville, the Georgia Department of Community Affairs (DCA), and the Middle Georgia Regional Development Center.

The Middle Georgia Regional Development Center and the City of Hawkinsville do not assume responsibility for the legal accuracy of the information or features represented on this map series. Use of this map series should be limited to general planning purposes only.

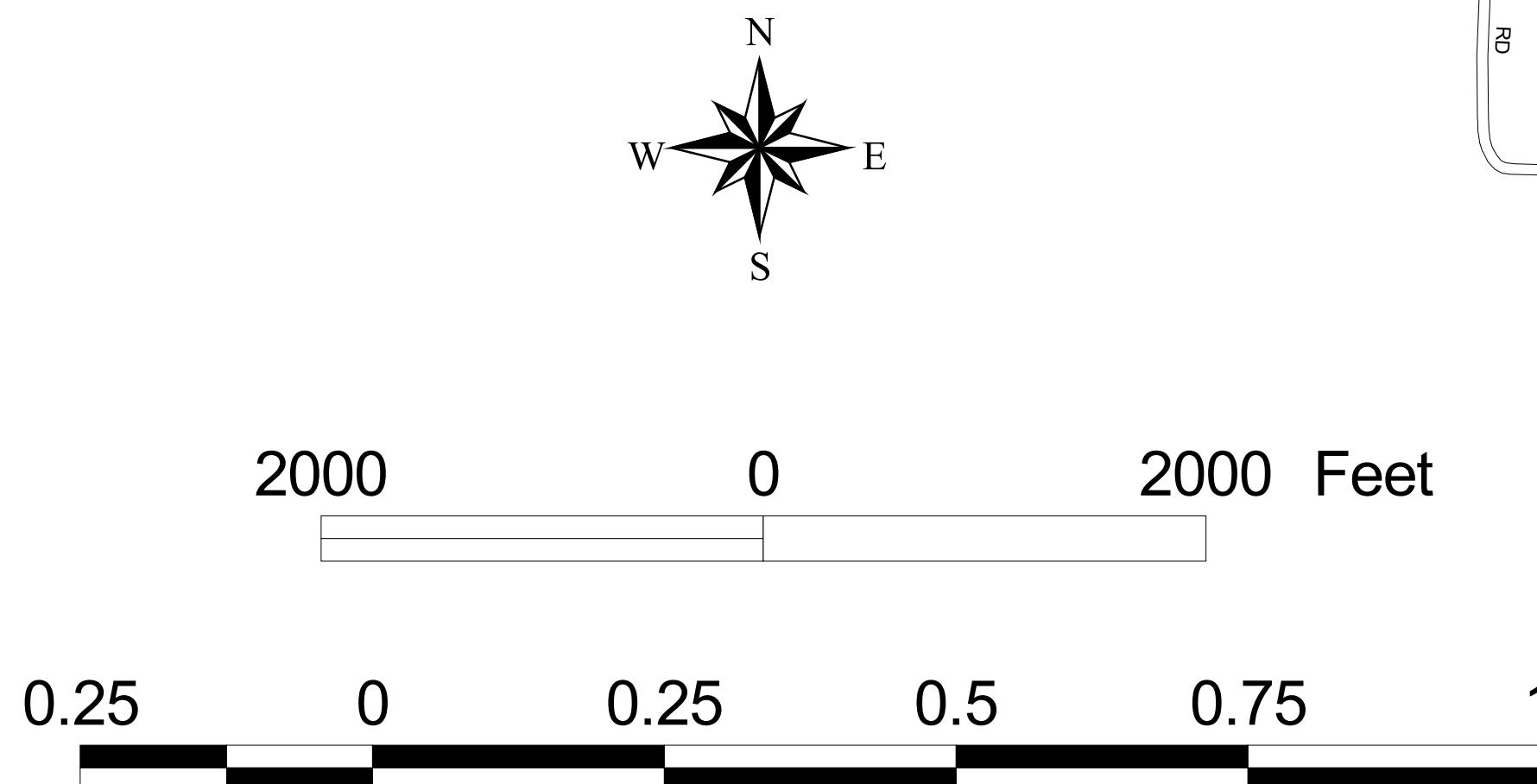

CITY	OF	HAWKINSVILLE,	GEORGIA	ALPHA-NUMERIC	STREET	REFERENCE	INDEX
ACADEMY STREET	D4	CREEKWOOD DRIVE	C3	HARTFORD ROAD	E4	OLD EASTMAN HIGHWAY	E4, F4
ANDERSON ROAD	C4, D4	CURTIS STREET	C2	HENDRY WAY	D3, D4	S LAMAR STREET	D4
ANTHONY STREET	C3	DANIEL STREET	D4	HERMISTON STREET	B2	S MASHBURN STREET	D4
ARROWHEAD PT'S	C4	DOGWOOD STREET	B3, B4	HIGHLAND AVENUE	D3	S MITCHELL STREET	C4
BARTO STREET	D4	DOUGWOOD TRAIL	B3	HILL BRIGHT STREET	C2	S UNION STREET	D4, D5
BENBURY CIRCLE	D4	DOUGLAS STREET	C2	HILL CREST AVENUE	C3	S WOOD STREET	D4
BOAT WAMP	F5	EAST STREET	C2, C3	HILLTOP ROAD	C3	SANDY DRIVE	F4
BOEING STREET	B2, C2	EAST STREET	C2	HOLLY HILL DRIVE	B3	SANTRY SPRINGS CIRCLE	B4, C4, D4, E4
BOYER STREET	B2, C2, C3	FARMWAY DRIVE	D3, B3	INDUSTRIAL BOULEVARD	C2, D2, D3	SEWELL ROAD	C3
BRANCH STREET	C4, D4	FARMWAY LANE	B2, B3	JAMES STREET	D4	SOUTH STREET	D4
BROOKSIDE DRIVE	B4, B4	FALE STREET	D4	JULIUS STREET	D4	SPRING VALLEY DRIVE	B4, C4, D4, E4
BROWNWOOD DRIVE	C5, D5	FIFTH STREET	D3	JUNIOR STREET	C4	SR 1, US 341, US 129	B4, C4, D4, E4
BURNETT ROAD	F4	FIRE ROAD 905	C3	JUNIOR SIMPSON ROAD	B4, B5	SR 230, US 341	B4, C4, D4, E4
CARROLLING STREET	D5	FIRST STREET	D4, E4	KAMELA DRIVE	C5	SR 26, SR 257	C3, D4, D5
CARTERS STREET	D3, D4	FLEMING ROAD	D3	KING RICHARD ROAD	B4	SR 1, US 341, US 129	C3, D4, D5
CENETERIES	D3, E3	FLORIDA AVENUE	E4	KNOTTYRINE STREET	D3	SR 26, SR 257	C3, D4, D5
CHERRY STREET	C3	FOREST HILL CIRCLE	C4	KNOXVILLE STREET	D3	SR 1, US 341, US 129	C3, D4, D5
CLARK DRIVE	C5	FRANKLIN STREET	D3	LAKESIDE COMPLEX	C4	SUNNY BROOK CIRCLE	C4
COMMERCE COURT	D4	FREEMAN ROAD	F4	LAKESIDE DRIVE	C4	SUNSET STRIP	C3
COMMERCE STREET	A3, C3, C4, F4	FRUIT TUCK ROAD	B4	LAUREL HILL ROAD	B3, C3	TARGET AVENUE	D4
COUNTRY CLUB DRIVE	B3, C3	GRACE STREET	D4	LEONORA DRIVE	C4	TEMS AVENUE	D5, D4
CRAFTWAY CIRCLE	C5, D5	HART HOMES	D3				

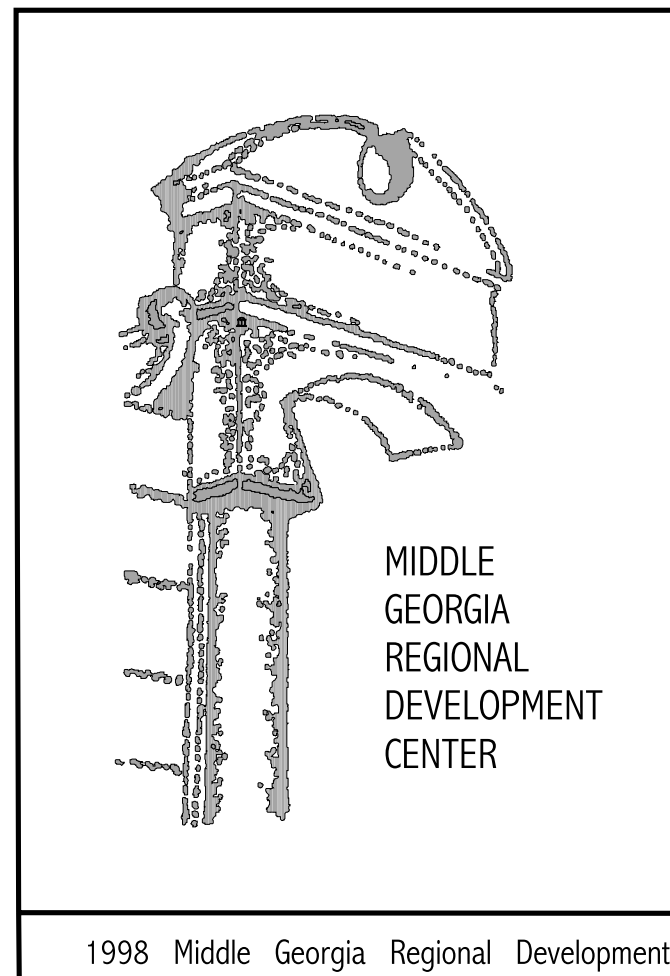

GEOGRAPHIC	FEATURE	LEGEND
National Wetlands Inventory Classifications		
PAB3H	Palustrine, Aquatic Bed, Rooted Vascular, Permanently Flooded	
PEM1C	Palustrine, Emergent, Persistent, Seasonally Flooded	
PEM1D	Palustrine, Emergent, Persistent, Seasonally Flooded, Partially Drained/Ditched	
PEM1F	Palustrine, Emergent, Persistent, Seasonally Flooded, Diked/Impounded	
PEM1H	Palustrine, Emergent, Persistent, Seasonally Flooded, Diked/Impounded	
PEM1J	Palustrine, Emergent, Persistent, Seasonally Flooded, Diked/Impounded	
PEM1K	Palustrine, Emergent, Persistent, Seasonally Flooded, Diked/Impounded	
PEM1L	Palustrine, Emergent, Persistent, Seasonally Flooded, Diked/Impounded	
PEM1M	Palustrine, Emergent, Persistent, Seasonally Flooded, Diked/Impounded	
PEM1N	Palustrine, Emergent, Persistent, Seasonally Flooded, Diked/Impounded	
PEM1O	Palustrine, Emergent, Persistent, Seasonally Flooded, Diked/Impounded	
PEM1P	Palustrine, Emergent, Persistent, Seasonally Flooded, Diked/Impounded	
PEM1Q	Palustrine, Emergent, Persistent, Seasonally Flooded, Diked/Impounded	
PEM1R	Palustrine, Emergent, Persistent, Seasonally Flooded, Diked/Impounded	
PEM1S	Palustrine, Emergent, Persistent, Seasonally Flooded, Diked/Impounded	
PEM1T	Palustrine, Emergent, Persistent, Seasonally Flooded, Diked/Impounded	
PEM1U	Palustrine, Emergent, Persistent, Seasonally Flooded, Diked/Impounded	
PEM1V	Palustrine, Emergent, Persistent, Seasonally Flooded, Diked/Impounded	
PEM1W	Palustrine, Emergent, Persistent, Seasonally Flooded, Diked/Impounded	
PEM1X	Palustrine, Emergent, Persistent, Seasonally Flooded, Diked/Impounded	
PEM1Y	Palustrine, Emergent, Persistent, Seasonally Flooded, Diked/Impounded	
PEM1Z	Palustrine, Emergent, Persistent, Seasonally Flooded, Diked/Impounded	
PEM2A	Palustrine, Emergent, Persistent, Seasonally Flooded, Diked/Impounded	
PEM2B	Palustrine, Emergent, Persistent, Seasonally Flooded, Diked/Impounded	
PEM2C	Palustrine, Emergent, Persistent, Seasonally Flooded, Diked/Impounded	
PEM2D	Palustrine, Emergent, Persistent, Seasonally Flooded, Diked/Impounded	
PEM2E	Palustrine, Emergent, Persistent, Seasonally Flooded, Diked/Impounded	
PEM2F	Palustrine, Emergent, Persistent, Seasonally Flooded, Diked/Impounded	
PEM2G	Palustrine, Emergent, Persistent, Seasonally Flooded, Diked/Impounded	
PEM2H	Palustrine, Emergent, Persistent, Seasonally Flooded, Diked/Impounded	
PEM2I	Palustrine, Emergent, Persistent, Seasonally Flooded, Diked/Impounded	
PEM2J	Palustrine, Emergent, Persistent, Seasonally Flooded, Diked/Impounded	
PEM2K	Palustrine, Emergent, Persistent, Seasonally Flooded, Diked/Impounded	
PEM2L	Palustrine, Emergent, Persistent, Seasonally Flooded, Diked/Impounded	
PEM2M	Palustrine, Emergent, Persistent, Seasonally Flooded, Diked/Impounded	
PEM2N	Palustrine, Emergent, Persistent, Seasonally Flooded, Diked/Impounded	
PEM2O	Palustrine, Emergent, Persistent, Seasonally Flooded, Diked/Impounded	
PEM2P	Palustrine, Emergent, Persistent, Seasonally Flooded, Diked/Impounded	
PEM2Q	Palustrine, Emergent, Persistent, Seasonally Flooded, Diked/Impounded	
PEM2R	Palustrine, Emergent, Persistent, Seasonally Flooded, Diked/Impounded	
PEM2S	Palustrine, Emergent, Persistent, Seasonally Flooded, Diked/Impounded	
PEM2T	Palustrine, Emergent, Persistent, Seasonally Flooded, Diked/Impounded	
PEM2U	Palustrine, Emergent, Persistent, Seasonally Flooded, Diked/Impounded	
PEM2V	Palustrine, Emergent, Persistent, Seasonally Flooded, Diked/Impounded	
PEM2W	Palustrine, Emergent, Persistent, Seasonally Flooded, Diked/Impounded	
PEM2X	Palustrine, Emergent, Persistent, Seasonally Flooded, Diked/Impounded	
PEM2Y	Palustrine, Emergent, Persistent, Seasonally Flooded, Diked/Impounded	
PEM2Z	Palustrine, Emergent, Persistent, Seasonally Flooded, Diked/Impounded	